

# D 28 70/76 mm

**SEMI FINISHED  
BIFOCAL**

**mineral 1.525  
WHITE, PBX, PGX**

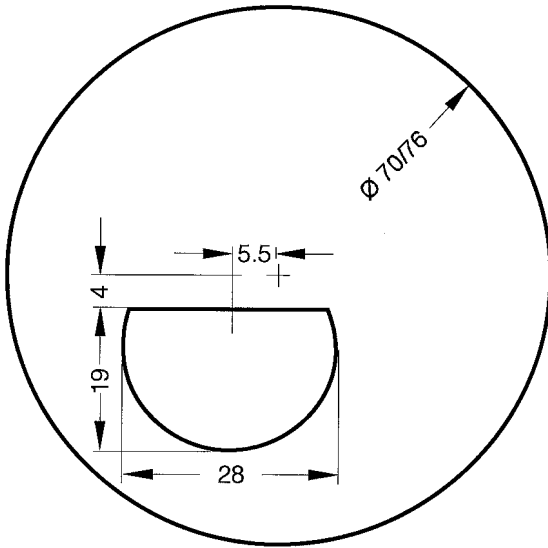

Refractive Index $n_e$	1.525		
	WHITE	PBX	PGX
Abbe Value $v_e$	58.5	56.2	56.7
Density [g/cm <sup>3</sup> ]	2.61	2.41	2.41
99% UV-Protection	330	335	335

WHITE	Addition [dpt]																		
Base	0.50	0.75	1.00	1.25	1.50	1.75	2.00	2.25	2.50	2.75	3.00	3.25	3.50	3.75	4.00	4.50	5.00	5.50	6.00
0.00																			
2.00																			
4.25		●	●	●	●	●	●	●	●	●	●	●	●	●	●				
6.25		●	●	●	●	●	●	●	●	●	●	●	●	●	●				
8.25		●	●	●	●	●	●	●	●	●	●	●	●	●	●				
10.25																			

PBX	Addition [dpt]																		
Base	0.50	0.75	1.00	1.25	1.50	1.75	2.00	2.25	2.50	2.75	3.00	3.25	3.50	3.75	4.00	4.50	5.00	5.50	6.00
0.00																			
2.00																			
4.25		●	●	●	●	●	●	●	●	●	●	●	●	●	●				
6.25		●	●	●	●	●	●	●	●	●	●	●	●	●	●				
8.25		●	●	●	●	●	●	●	●	●	●	●	●	●	●				
10.25																			

PGX	Addition [dpt]																		
Base	0.50	0.75	1.00	1.25	1.50	1.75	2.00	2.25	2.50	2.75	3.00	3.25	3.50	3.75	4.00	4.50	5.00	5.50	6.00
0.00																			
2.00																			
4.25		●	●	●	●	●	●	●	●	●	●	●	●	●	●				
6.25		●	●	●	●	●	●	●	●	●	●	●	●	●	●				
8.25		●	●	●	●	●	●	●	●	●	●	●	●	●	●				
10.25																			

● stock range

5 0000 778

Version  
1C1AZ17D

Date  
05.02.2013

**TIC Optics GmbH**

Page  
24